

Architects Notes

Drawing is based on existing drawings provided by previous Architect and as such Logic Architecture Ltd make no guarantees as to its accuracy.

The topographical features as illustrated are thus approximate and subject to a detailed Topographical Survey.

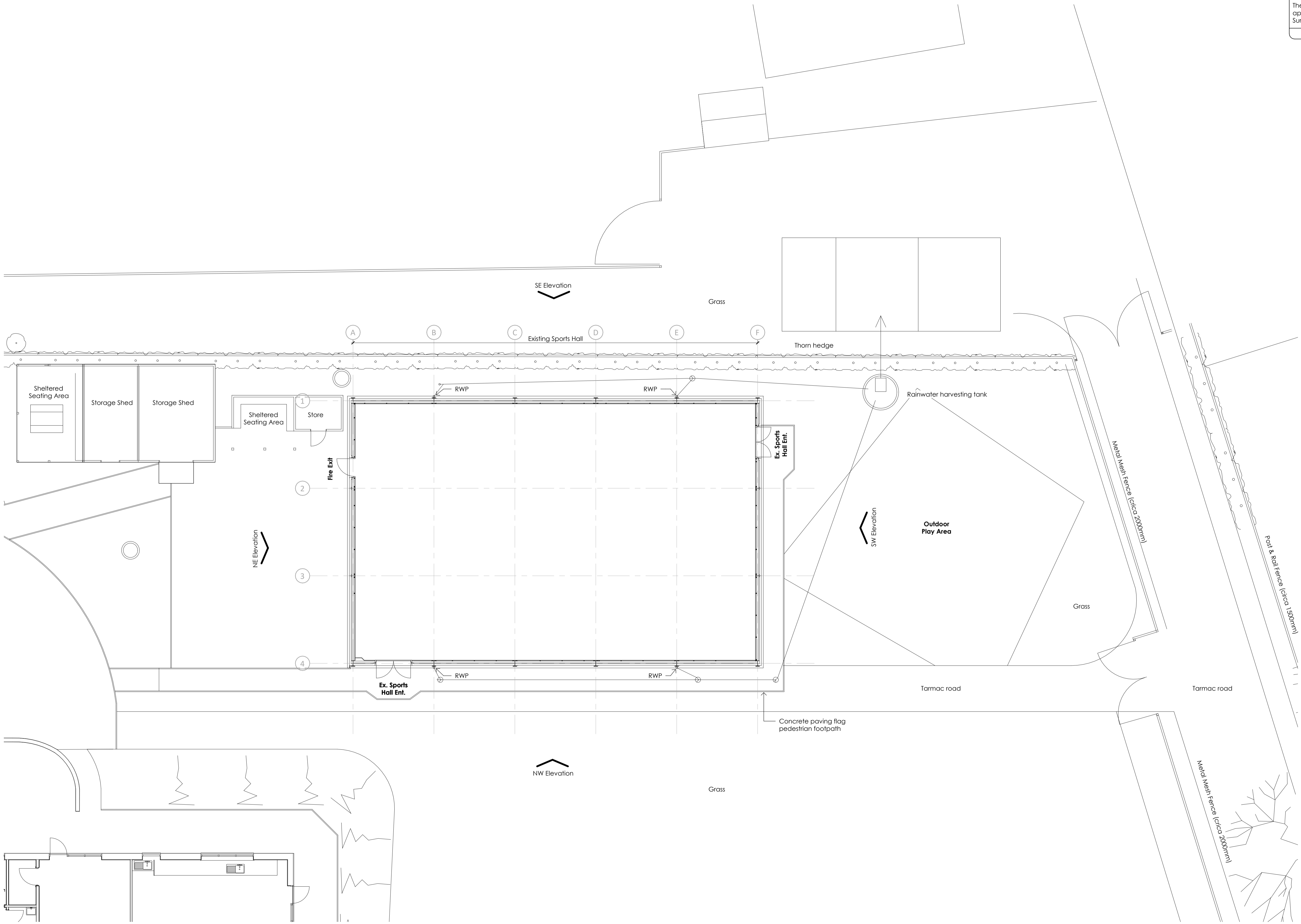

P1	Planning Issue	EMS	15-05-24
Rev	Issue	Drawn	Chkd Date

logic

- Boho 7 | Queens Square | Middlesbrough | TS2 1PA (01642) 309307
- Palace Hub | Esplanade | Redcar | TS10 3AE (01642) 309307
- Morwick Hall | Martec Office Park | York Road | Leeds | LS15 4TA (0113) 823 2888

E: admin@logicarchitecture.com W: logicarchitecture.com

Client Mowbray School			
Project Mowbray School Sports Hall Alterations and Extension			
Drawing Existing External Works			
Scale	1 : 100	@ A1	Author EMS
Date	02/27/24	Checked	MB

Status	PLANNING	Client No.	Revision
Project No.	Originator	Zone	Level
2401 -LAL-	XX-RF-	DR-A-00-102	P1