



DO NOT SCALE

- NYCC Highway Boundary
- Red Line Boundary
- Existing Features: Retained Trees, Retained Ancient Veteran Trees, Retained Woodland, Retained Hedge
- Proposed Vegetation Types: W1 - Broadleaf Deciduous Woodland Mix, W2 - Wet Woodland Mix, W3 - Woodland Edge Mix, W4 - Individual Tree (Extra Heavy), W5 - Individual Tree (Feathered), W6 - Scrub, G1 Highway verge and Visibility Splays, G2 Wildflower and Grass Meadow for Acid Soils, G3 Upland Heathland/Acid Grassland/Agricultural Pasture (Allow for 5% of Heather seed to be sourced via local landowner...), G4 Wet Grassland (Alongside Hall Beck watercourse...), G5 Wildflower and Grass Meadow Mix for Neutral Soils (Pollinator Mix), G6 Woodland Wildflower and Grass Mix, Watercourse, Open Water, Timber Post and Rail Tree Guard, Riverine Stone and Gravel

- Notes:
- All works within the NYCC Highway boundary to be the responsibility of the NYCC Highways Department from the end of the 5-Year Establishment Period.
 - Areas of land outwith the NYCC Highways boundary will revert to the Landowner for ongoing maintenance.

NOTE - CONSTRUCTION ISSUE C03

- Amendments to the design at Church Hill (minor amendments to the boundary treatments to allow for the road reconfiguration, and gates altered at church car park);
- Amendments to the design at Hall Lane (minor amendments to the boundary treatments to allow for the road reconfiguration);
- Diversion of Hall Beck (alteration to watercourse alignment and design);
- Soft landscaping around drainage areas including Attenuation Ponds (refer to Point 6);
- Siting of interceptor channels and filter drains (soft landscaping around changes in Point 3);
- Variation in slope angle on certain sections (change in type of planting in certain areas due to underlying geotechnical feature placement associated with soil stability);
- Inclusion of reinstatement works for areas used as temporary construction compounds;
- Areas of woodland and scrub planting are to be reconfigured, following recent tree clearances; and
- No. 8 additional tree guards will be provided within livestock fields near Blubberhouses Hall to protect growing trees.

REV	DATE	BY	DESCRIPTION	CHK	APP
C03	21/08/2023	MM	FOR CONSTRUCTION	SF	AW
C02	24/03/2023	MM	CONTRACTORS STORAGE AREAS REVISED	SF	AW
C01	01/02/2023	MM	CONSTRUCTION ISSUE BASED ON HIGHWAY DESIGN VERSION JUNE 2021	SF	AW
T02	18/06/2020	CM	TENDER CONSULTATION EDITS	SF	AW
T01	26/11/2019	LA	FIRST ISSUE	SF	AW

DRAWING STATUS: S3 - FOR REVIEW

wsp

No 8 First Street, Manchester, M15 4RP, UK
T+ 44 (0) 161 200 5000
wsp.com

CLIENT: North Yorkshire County Council

ARCHITECT: wsp

SITE/PROJECT: A59 KEX GILL DIVERSION

TITLE: Soft Landscape: Planting Plan (Sheet 6 of 15)

SCALE @ A1: 1:500	CHECKED: SF	APPROVED: AW
PROJECT NO: 70049554	DESIGNED: SF	DRAWN: MM
DRAWING NO: NYKGDD-WSP-ELS-SG-DR-LE-00016	DATE: 21/08/2023	REV: C03

© WSP UK Ltd

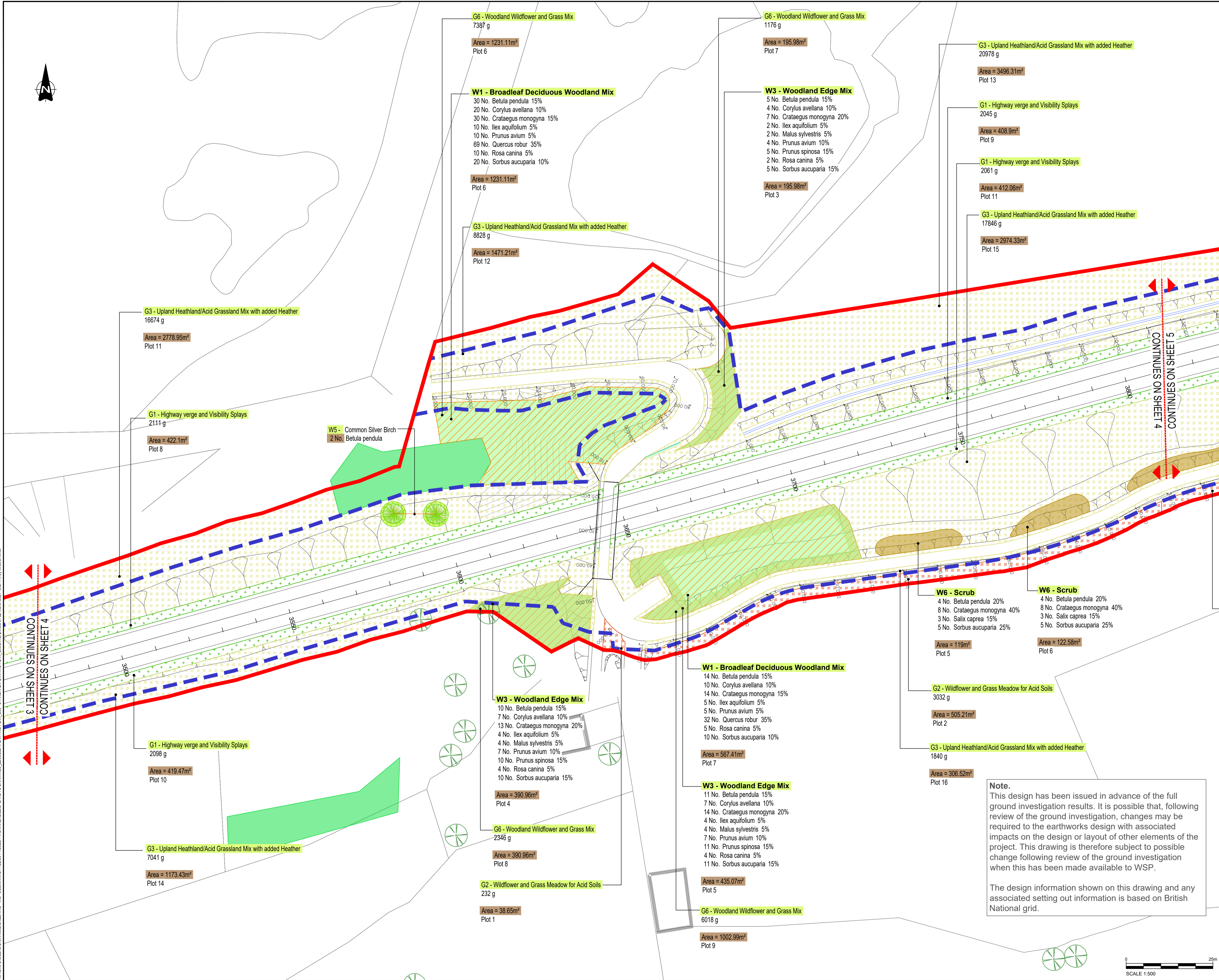

File name: C:\USERS\MM\WORKSPACE\WSP\085\MM\OFFICE\PROJECT WORK\KEXGILL\UPDATE TO DRAWINGS_22102024\PLANTING PLAN_CD3 - STANDARD\PLANTING PLAN_CD3.DWG, printed on 22 March 2024 13:27:44, by Waihan, Minal