



Note.
This design has been issued in advance of the full ground investigation results. It is possible that, following review of the ground investigation, changes may be required to the earthworks design with associated impacts on the design or layout of other elements of the project. This drawing is therefore subject to possible change following review of the ground investigation when this has been made available to WSP.

The design information shown on this drawing and any associated setting out information is based on British National grid.

DO NOT SCALE

- NYCC Highway Boundary
- Red Line Boundary
- Retained Trees
- Retained Ancient Veteran Trees
- Retained Woodland
- Retained Hedge
- G1 Highway Verge and Visibility Splay (Pollinator Mix - Mown to maintain height of 0.26)
- G2 Wildflower and Grass Meadow for Acid Soils
- G3 Upland Heathland/ Acid Grassland- Agricultural Pasture (Allow for 5% of Heather seed to be sourced via local landowner, the remaining to be sourced commercially due to quantity required)
- G4 Wet Grassland (Alongside Hall Beck watercourse and within Attenuation Pond. Allow areas to recolonise naturally. No seed mix necessary in these areas)
- G5 Wildflower and Grass Meadow Mix for Neutral Soils (Pollinator Mix)
- G6 Woodland Wildflower and Grass Mix
- Watercourse
- Open Water
- Timber Post and Rail Tree Guard
- Riverine Stone and Gravel
- W1 - Broadleaf Deciduous Woodland Mix
- W2 - Wet Woodland Mix
- W3 - Woodland Edge Mix
- W4 - Individual Tree (Extra Heavy)
- W5 - Individual Tree (Feathered)
- W6 - Scrub

- Notes:
- All works within the NYCC Highway boundary to be the responsibility of the NYCC Highways Department from the end of the 5-Year Establishment Period.
 - Areas of land outwith the NYCC Highways boundary will revert to the Landowner for ongoing maintenance.

NOTE - CONSTRUCTION ISSUE C03

- Amendments to the design at Church Hill (minor amendments to the boundary treatments to allow for the road reconfiguration, and gates altered at church car park);
- Amendments to the design at Hall Lane (minor amendments to the boundary treatments to allow for the road reconfiguration);
- Diversion of Hall Beck (alteration to watercourse alignment and design);
- Soft landscaping around drainage areas including Attenuation Ponds (refer to Point 6);
- Siting of interceptor channels and filter drains (soft landscaping around changes in Point 3);
- Variation in slope angle on certain sections (change in type of planting in certain areas due to underlying geotechnical feature placement associated with soil stability);
- Inclusion of reinstatement works for areas used as temporary construction compounds;
- Areas of woodland and scrub planting are to be reconfigured, following recent tree clearances; and
- No. 8 additional tree guards will be provided within livestock fields near Blubberhouses Hall to protect growing trees.

REV	DATE	BY	DESCRIPTION	CHK	APP
C03	21/08/2023	MM	FOR CONSTRUCTION	SF	AW
C02	24/03/2023	MM	CONTRACTORS STORAGE AREAS REVISED	SF	AW
C01	01/02/2023	MM	CONSTRUCTION ISSUE BASED ON HIGHWAY DESIGN VERSION JUNE 2021	SF	AW
T01	18/06/2020	CM	TENDER CONSULTATION EDITS	SF	AW
T02	28/11/2019	LA	FIRST ISSUE	SF	AW

DRAWING STATUS: S3 - FOR REVIEW

No 8 First Street, Manchester, M15 4RP, UK
T+ 44 (0) 161 200 5000
wsp.com

CLIENT: A59 KEX GILL DIVERSION

ARCHITECT: WSP

SITE/PROJECT: A59 KEX GILL DIVERSION

TITLE: Soft Landscape: Planting Plan (Sheet 7 of 15)

SCALE @ A1: 1:500	CHECKED: SF	APPROVED: AW
PROJECT NO: 70049554	DESIGNED: SF	DATE: 21/08/2023
DRAWING NO: NYKGGD-WSP-ELS-SG-DR-LE-00017	REV: C03	

© WSP UK Ltd

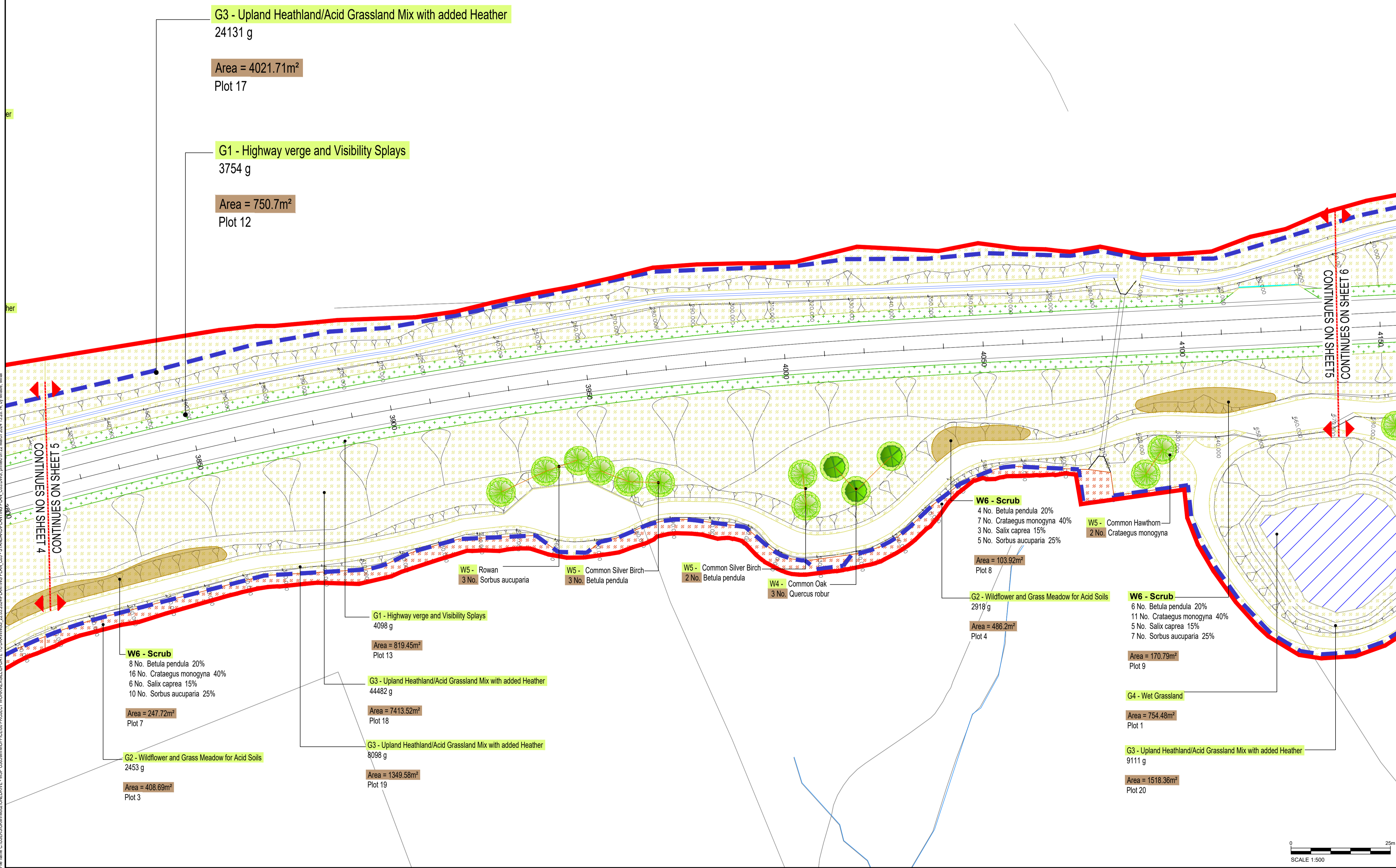

This drawing may contain: Ordnance Survey data © Crown copyright and database right 2023.