

DO NOT SCALE

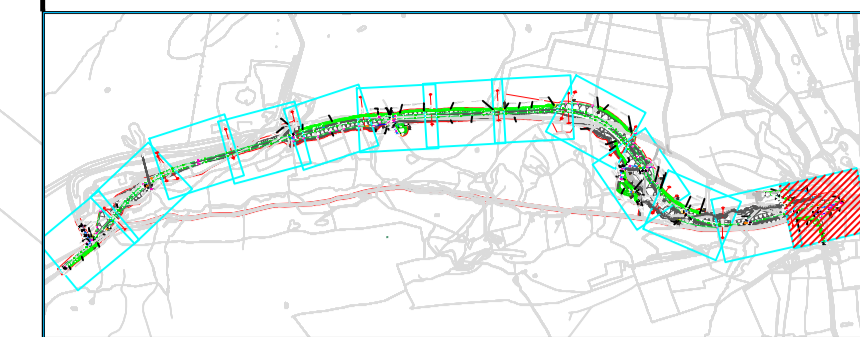

LOCATION PLAN
SCALE NTS

- NOTES
- THE DETAILS PROVIDED IN THIS DRAWING ARE LOCATED TO ORDNANCE SURVEY (OS) BRITISH NATIONAL GRID COORDINATES
 - DRAWING TO BE PRINTED IN COLOUR
 - THIS DRAWING SHALL BE READ IN CONJUNCTION WITH ALL RELEVANT REFERENCE DRAWINGS, SPECIFICATIONS, AND SCHEDULES
 - THE CONTRACTOR SHALL BE RESPONSIBLE FOR THE ACCURACY OF ALL THE DIMENSIONS AND FOR THE CORRECT SETTING OUT OF THE WORK ON SITE DO NOT SCALE FROM THIS DRAWING. WORK FROM FIGURED DIMENSIONS AND SCHEDULES ONLY
 - ALL DIMENSIONS ARE IN MILLIMETRES. ALL LEVELS ARE IN METERS UNLESS STATED OTHERWISE. CHANGES ARE IN METERS
 - THE POSITION AND LEVELS OF ALL DRAINS ARE TO BE CONFIRMED ON SITE PRIOR TO THE COMMENCEMENT OF THE WORKS AND ANY DISCREPANCIES REPORTED IMMEDIATELY TO THE SUPERVISOR
 - ALL DRAINAGE TO COMPLY WITH THE REQUIREMENT OF DESIGN MANUAL FOR ROADS AND BRIDGES - VOLUME 4
 - CONNECTIONS TO MAIN HIGHWAY DRAINS ARE TO BE "Y" JUNCTIONS
 - ANY WORKS AFFECTING EXISTING WATERCOURSES REQUIRE ENVIRONMENT AGENCY AND / OR LOCAL AUTHORITY APPROVAL
 - THE PROPOSED OUTFALL LOCATIONS, EXISTING GROUND LEVELS, INVERT LEVELS, THE EXISTING RECEIVING CHANNEL BED LEVELS AND EXACT EMBANKMENT SLOPES ARE UNKNOWN AND THE DESIGN HAS BEEN BASED ON LIDAR INFORMATION. THE CONTRACTOR IS THEREFORE REQUIRED TO UNDERTAKE A FULL SURVEY OF THE EXISTING AND PROPOSED OUTFALL LOCATIONS AND RECEIVING WATERCOURSE DETAILS PRIOR TO CONSTRUCTION. THIS SURVEY INFORMATION WILL NEED TO BE PROVIDED TO THE CLIENT'S PROJECT MANAGER/SUPERVISOR FOR REVIEW AND APPROVAL PRIOR TO CONSTRUCTION.
 - THE LOCATION OF THE EXISTING AND PROPOSED HIGHWAY CULVERT STRUCTURES AND THE EXISTING AND REALIGNED WATERCOURSE ARE SHOWN INDICATIVELY ONLY ON THIS DRAWING. FOR ACCURATE WATERCOURSE ALIGNMENT, REALIGNMENT DETAILS, PROPOSED CULVERT DETAILS, LANDSCAPING DETAILS, INTERCEPTOR CHANNEL DETAILS, REFER TO THE INDIVIDUAL DESIGN DRAWINGS FOR EACH DISCIPLINE FOR MORE INFORMATION. FOR TYPICAL CROSS SECTION DETAILS OF THE PROPOSED INTERCEPTOR CHANNELS A AND B, REFER TO DRAWING REF NYKGGD-WSP-HDG-SG-DR-CD-0500_0019 AND LINING DETAILS IN DRAWING REF NYKGGD-WSP-HDG-SG-DR-CD-0500_0020
 - POLLUTION CONTROL UNITS TO BE IN ACCORDANCE WITH THE POLLUTION CONTROL UNIT SCHEDULE. REF NYKGGD-WSP-HDG-SG-DR-CD-00001
 - THE PROPOSED OUTFALL HEADWALLS TO BE IN ACCORDANCE WITH THE HEADWALL DRAWING NYKGGD-WSP-HDG-SG-DR-CD-0500_0024
 - THE LOCATION OF THE EXISTING AND PROPOSED HIGHWAY CULVERT STRUCTURES AND THE EXISTING AND REALIGNED WATERCOURSE ARE SHOWN INDICATIVELY ONLY ON THIS DRAWING. FOR ACCURATE WATERCOURSE ALIGNMENT, REALIGNMENT DETAILS, PROPOSED CULVERT DETAILS, LANDSCAPING REFER TO THE INDIVIDUAL DESIGN DRAWINGS FOR EACH DISCIPLINE FOR MORE INFORMATION.
 - THE SETTING OUT POINTS FOR CULVERT 1 & 2 AND THE ASSOCIATED INTERCEPTOR CHANNELS ARE PROVIDED IN THE DRAINAGE SCHEDULE NYKGGD-WSP-HDG-SG-DR-CD-00001. THESE ARE TO BE USED IN CONJUNCTION WITH THE 3D MODEL PROVIDED.
 - THE 3D MODEL IS BASED ON EXISTING LIDAR DATA AND THEREFORE ALL LEVELS ARE TO BE CONFIRMED ON SITE AND ANY DISCREPANCIES REPORTED IMMEDIATELY TO THE SUPERVISOR.
 - FOR TYPICAL CROSS SECTION DETAILS OF THE PROPOSED INTERCEPTOR CHANNELS A AND B, REFER TO DRAWING NYKGGD-WSP-HDG-SG-DR-CD-0500_0019 AND LINING DETAILS IN DRAWING NYKGGD-WSP-HDG-SG-DR-CD-0500_0020
 - FOR INTERCEPTOR CHANNELS AND ASSOCIATED CULVERT 1 AND 2 DETAILS REFER TO DRAWING NYKGGD-WSP-HDG-SG-DR-CD-0500_0019 TO NYKGGD-WSP-HDG-SG-DR-CD-0500_0024
 - WILD LIFE REFUGE 'ROCK ROLLS' TO BE INSTALLED EVERY 50M ALONG THE INTERCEPTOR CHANNELS. FOR DETAILS REFER TO DRAWING NYKGGD-WSP-HDG-SG-DR-CD-0500_0021
 - BED & SLOPE PROTECTION ARRANGEMENTS (ROCK ARMOUR) TO BE INSTALLED AT THE IN POINTS FOR THE INTERCEPTOR CHANNELS AND EXISTING/PROPOSED WATERCOURSES. FOR DETAILS REFER TO DRAWING NYKGGD-WSP-HDG-SG-DR-CD-0500_0022

CO1	31/07/2023	MA	FOR CONSTRUCTION	BB	
REV	DATE	BY	DESCRIPTION	CHK	APP

DRAWING STATUS: S3 - FOR REVIEW

Three White Rose Office Park, Millshaw Park Lane, Leeds, LS11 0DL, UK
T +44 (0) 113 395 6200, F +44 (0) 113 395 6201
wsp.com

CLIENT: North Yorkshire County Council

DESIGNER: WSP

SITE/PROJECT: A59 KEX GILL DIVERSION

TITLE: HIGHWAY DRAINAGE GENERAL ARRANGEMENTS SHEET 13 OF 13

SCALE @ A1:	1:500	CHECKED:	BB	APPROVED:	MW
PROJECT NO:	70049554	DESIGNED:	BB	DRAWN:	MA
				DATE:	31/07/2023

DRAWING NO: NYKGGD-WSP-HDG-SG-DR-CD-0500_013

REV: C01

© WSP UK Ltd

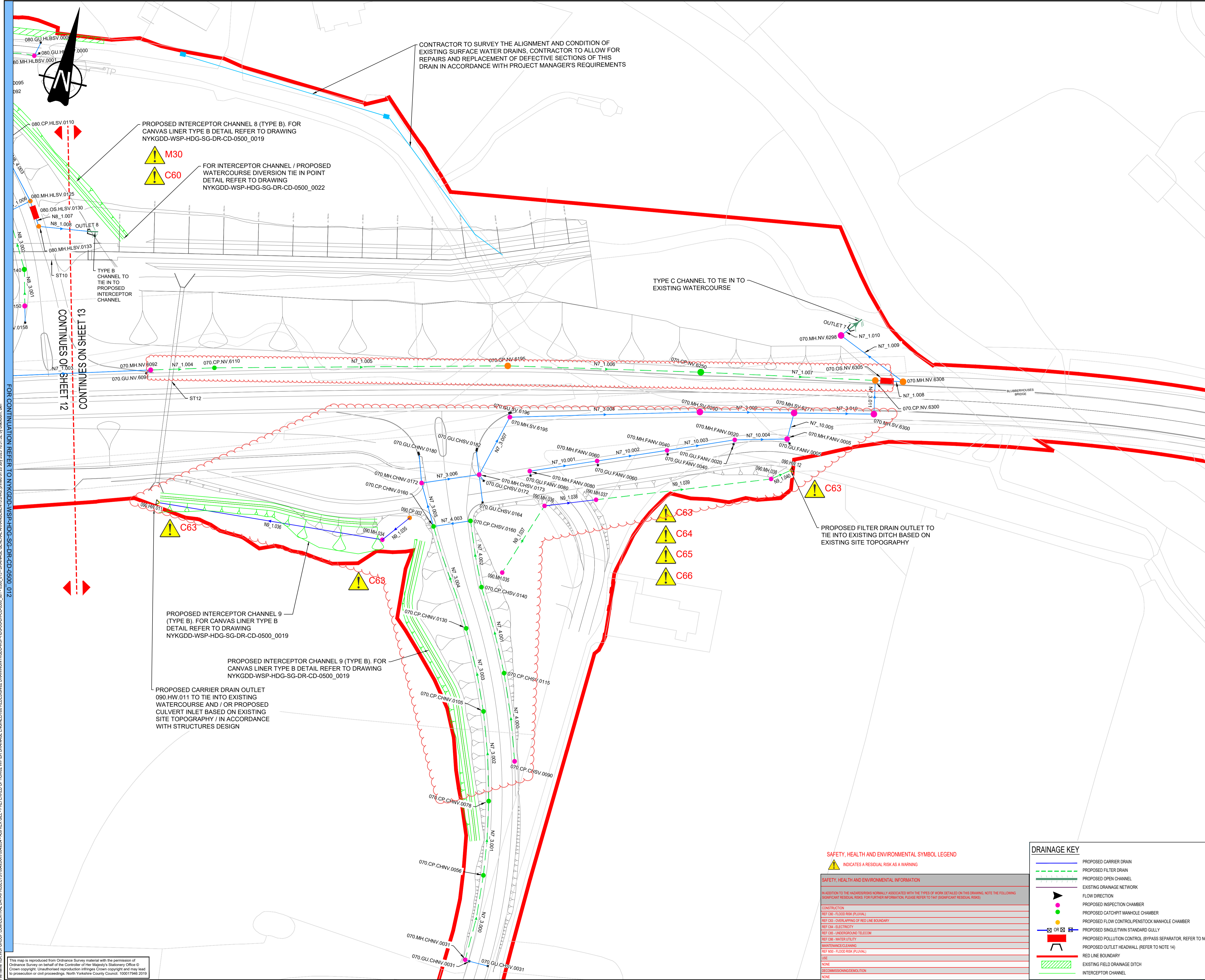

FOR CONTINUATION REFER TO NYKGGD-WSP-HDG-SG-DR-CD-0500_012

This map is reproduced from Ordnance Survey material with the permission of Ordnance Survey on behalf of the Controller of Her Majesty's Stationery Office © Crown copyright. Unauthorised reproduction infringes Crown copyright and may lead to prosecution or civil proceedings. North Yorkshire County Council. 100017046.01010

SAFETY, HEALTH AND ENVIRONMENTAL SYMBOL LEGEND

INDICATES A RESIDUAL RISK AS A WARNING

SAFETY, HEALTH AND ENVIRONMENTAL INFORMATION

IN ADDITION TO THE HAZARD RISKS NORMALLY ASSOCIATED WITH THE TYPES OF WORK DETAILED ON THIS DRAWING, NOTE THE FOLLOWING SIGNIFICANT RESIDUAL RISKS. FOR FURTHER INFORMATION, PLEASE REFER TO T447 (SIGNIFICANT RESIDUAL RISKS)

CONSTRUCTION	
REF OS - FLOOD RISK (PLUVIAL)	
REF OS - OVERLAPPING OF FIELD LINE BOUNDARY	
REF OS - ELECTRICITY	
REF OS - UNDERGROUND TELECOM	
REF OS - WATER UTILITY	
MAINTENANCE/CLEANING	
REF OS - FLOOD RISK (PLUVIAL)	
USE	
NONE	
DECOMMISSIONING/DEMOLITION	
NONE	

DRAINAGE KEY

- PROPOSED CARRIER DRAIN
- PROPOSED FILTER DRAIN
- PROPOSED OPEN CHANNEL
- EXISTING DRAINAGE NETWORK
- FLOW DIRECTION
- PROPOSED INSPECTION CHAMBER
- PROPOSED CATCH/PT MANHOLE CHAMBER
- PROPOSED FLOW CONTROL/PENSTOCK MANHOLE CHAMBER
- PROPOSED SINGLE/TWIN STANDARD GULLY
- PROPOSED POLLUTION CONTROL (BYPASS SEPARATOR, REFER TO NOTE 13)
- PROPOSED OUTLET HEADWALL (REFER TO NOTE 14)
- RED LINE BOUNDARY
- EXISTING FIELD DRAINAGE DITCH
- INTERCEPTOR CHANNEL