

DO NOT SCALE

NOTES:

1. THIS DESIGN HAS BEEN ISSUED IN ADVANCE OF THE FULL GROUND INVESTIGATION RESULTS. IT IS POSSIBLE THAT, FOLLOWING REVIEW OF THE GROUND INVESTIGATION, CHANGES MAY BE REQUIRED TO THE EARTHWORKS DESIGN WITH ASSOCIATED IMPACTS ON THE DESIGN OR LAYOUT OF OTHER ELEMENTS OF THE PROJECT. THIS DRAWING IS THEREFORE SUBJECT TO POSSIBLE CHANGE FOLLOWING REVIEW OF THE GROUND INVESTIGATION WHEN THIS HAS BEEN MADE AVAILABLE AT WSP.

2. THE DESIGN INFORMATION SHOWN ON THIS DRAWING AND ANY ASSOCIATED SETTING OUT INFORMATION IS BASED ON LOCAL GRID.

Scale H=1:1250 V=1:250
Level Datum =263.000

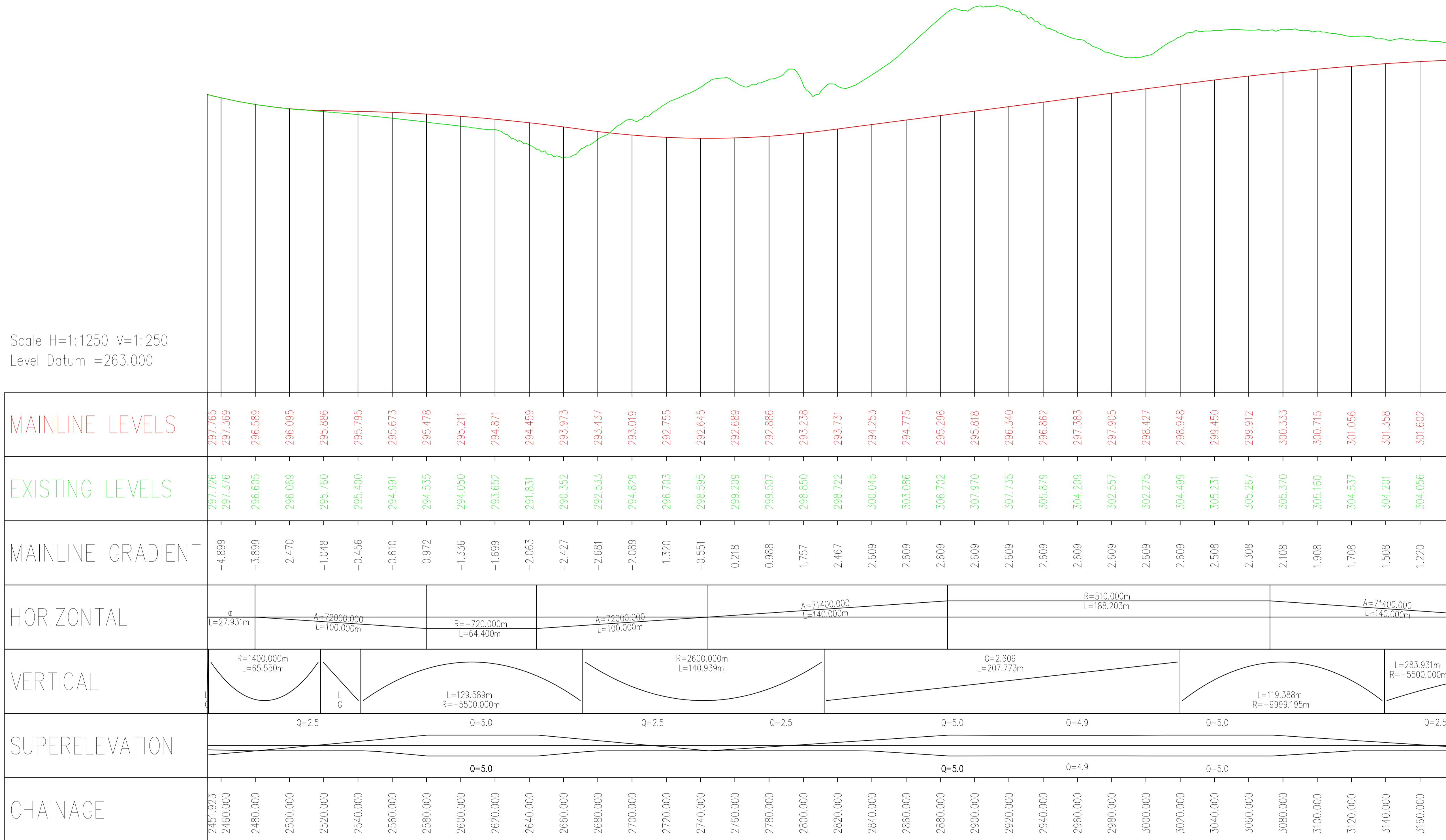

REV	DATE	BY	DESCRIPTION	CHK	APP
C01	28/10/2021	SI	FOR CONSTRUCTION	QU	RT

DRAWING STATUS: S3 - FOR REVIEW



CLIENT: North Yorkshire County Council

DESIGNER: WSP

SITE/PROJECT: A59 KEX GILL DIVERSION

TITLE: LONG SECTION (MAINLINE) SHEET 1 OF 6

SCALE @ A1:	CHECKED:	APPROVED:
AS SHOWN @ A1	MB	RT
PROJECT NO: 70049554	DESIGNED: LB	DRAWN: LB
		DATE: 10/06/2020

DRAWING NO:	REV:
NYKGDD-WSP-HML-S1-DR-CH-00001	C01

© WSP UK Ltd

File name: I:\UK_VSPGROUP\COMMON\DATA\PROJECTS\1046000\104654_A59KEXGILL_PREFERRED_OPTION02\WPHW\HIGHWAYS\2D\DRAWING\101-LONG SECTIONS\NYKGDD-WSP-HML-S1-DR-CH-00001\MANLINE.DWG, printed on 21 March 2024 17:59:04, by Markham, Dave