

NOTES:
GENERAL:
 1. ALL DIMENSIONS ARE IN MM UNLESS NOTED OTHERWISE.
 2. ALL LEVELS ARE IN METERS AOD UNLESS NOTED OTHERWISE.
 3. DO NOT SCALE IN CASE OF DOUBTS, OMISSIONS OR ERRORS. SEEK CLARIFICATION FROM THE DESIGNER.
 4. THE WORKS SHALL BE UNDERTAKEN IN ACCORDANCE WITH THE SPECIFICATION FOR HIGHWAY WORKS AND THE RELEVANT APPENDICES AND CONSTRUCTION ISSUE DRAWINGS.
 5. THE CONTRACTOR SHALL IN ADVANCE OF COMMENCING ANY SECTION OF WORKS, CONSULT WITH THE RELEVANT AUTHORITIES AND SATISFY THEMSELVES TO THE EXACT LINE/LEVEL AND NUMBER OF SERVICES INCLUDING ANY OTHER RELEVANT INFORMATION. THE CONTRACTOR SHALL COMPLY FULLY WITH ANY REQUIREMENTS THAT THE RELEVANT AUTHORITY HAS WITH REGARDS TO THE CONTRACTOR WORKING IN THE VICINITY OF THEIR APPARATUS. REFER TO APPENDIX 1/16 AND THE RELEVANT DRAWINGS FOR THE LATEST STATUTORY UNDERTAKERS INFORMATION. THE CONTRACTOR IS RESPONSIBLE FOR THE DIVERSION OF ALL SERVICES IMPACTING THE WORKS UNLESS STATED OTHERWISE.
 6. THE CONTRACTOR SHALL MEASURE AND CONFIRM ALL DIMENSIONS/LEVELS THAT HAVE A DIRECT IMPACT ON THE WORKS PRIOR TO EXECUTION. THE CONTRACTOR SHALL INFORM THE DESIGNER OF ANY AMBIGUITIES.
 7. THIS DRAWING SHALL BE READ IN CONJUNCTION WITH ALL RELEVANT DRAWINGS NYKGGD-WSP-SBR-ST004-DR-CB-0003 TO 0033.
GEOTECHNICAL REQUIREMENTS:
 8. A MAXIMUM 1 IN 3 SLOPE SHALL BE RETAINED BEHIND THE WING WALLS.
 9. THE ENDS OF THE PROPOSED UNDERPASS SHALL BE BACKFILLED WITH 6N/6P MATERIAL IN ACCORDANCE WITH THE 600 SPECIFICATION SERIES AND THE RELEVANT APPENDICES.
HEALTH AND SAFETY:
 10. THE CONTRACTOR SHALL REFER TO THE PRE-CONSTRUCTION H&S FILE FOR DETAILS OF THE H&S RISKS AND HOW THESE HAVE BEEN REDUCED/ELIMINATED DURING THE DESIGN PROCESS. KEY RESIDUAL RISK ARE RECORDED IN THE H&S TABLE AND HIGHLIGHTED ON THIS DRAWING.
GEOMETRY:
 11. WINGWALL DIMENSIONS AND SPLAY ANGLES SHOWN ARE INDICATIVE SUBJECT TO FINAL EARTHWORK PROFILE.

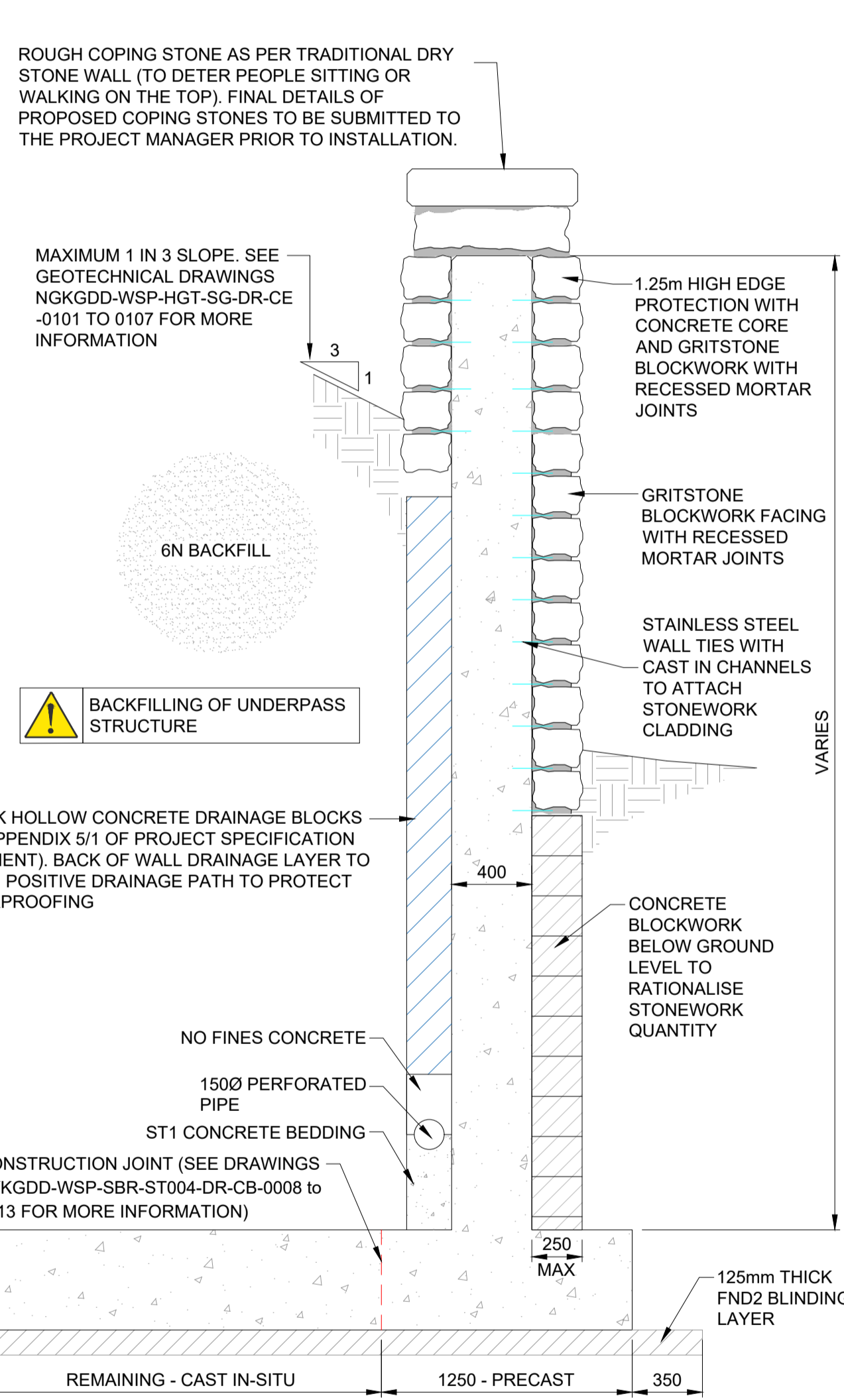

- INDICATIVE CONSTRUCTION SEQUENCE:**
1. SET UP SITE COMPOUND
 2. CONSTRUCT TEMPORARY ACCESS TRACK OFF NORTH MOOR ROAD TO ALLOW SITE TRAFFIC ACCESS
 3. WHERE REQUIRED, INSTALL TEMPORARY WORKS TO SUPPORT UNDERPASS EXCAVATION
 4. INSTALL PRECAST CONCRETE BOX SEGMENTS
 5. INSTALL WINGWALLS TO BOTH ENDS OF THE UNDERPASS
 6. INSTALL SPRAY APPLIED WATERPROOFING TO TOP OF CULVERT
 7. INSTALL BACK OF STRUCTURE DRAINAGE
 8. APPLY BITUMEN WATERPROOFING TO VERTICAL FACES
 9. BACKFILL STRUCTURE IN A STAGED MANNER SUCH THAT DIFFERENTIAL HEIGHTS DO NOT EXCEED 1m
 10. CONSTRUCT UNDERPASS ACCESS TRACK INCLUDING SURFACING AND VERGES
 11. INSTALL STONERWORK FACING TO THE HEADWALLS/WINGWALLS AT EACH END OF THE UNDERPASS
 12. INSTALL STONE WALL EDGE PROTECTION TO THE TOP OF THE HEADWALLS/WINGWALLS AT EACH END OF THE UNDERPASS
 13. CONSTRUCT THE NEW A59 ROAD ALIGNMENT INCLUDING SURFACING AND VERGES
 14. INSTALL VRS TO THE NEW A59 ROAD
 15. COMMISSION NEW A59 ROAD

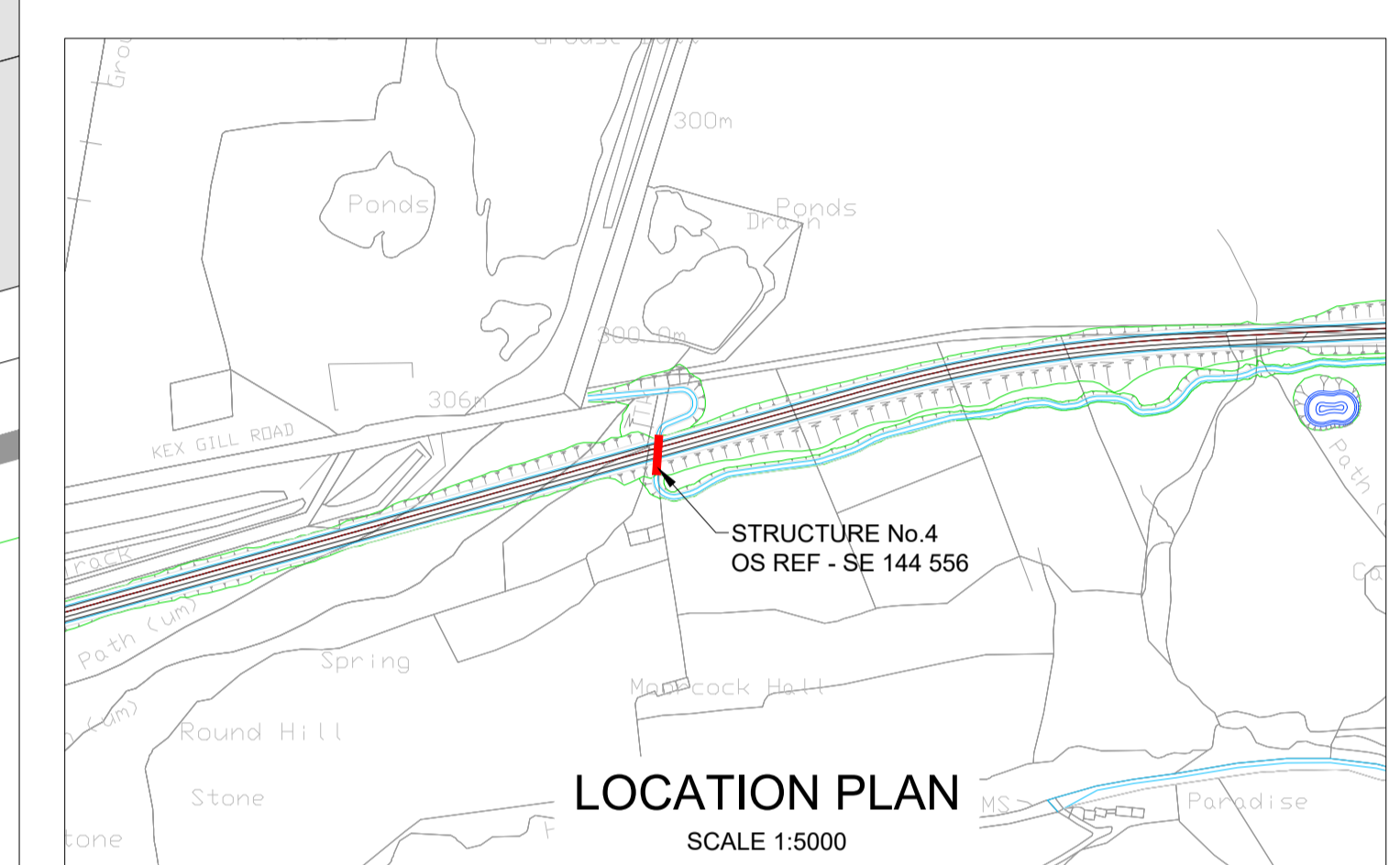
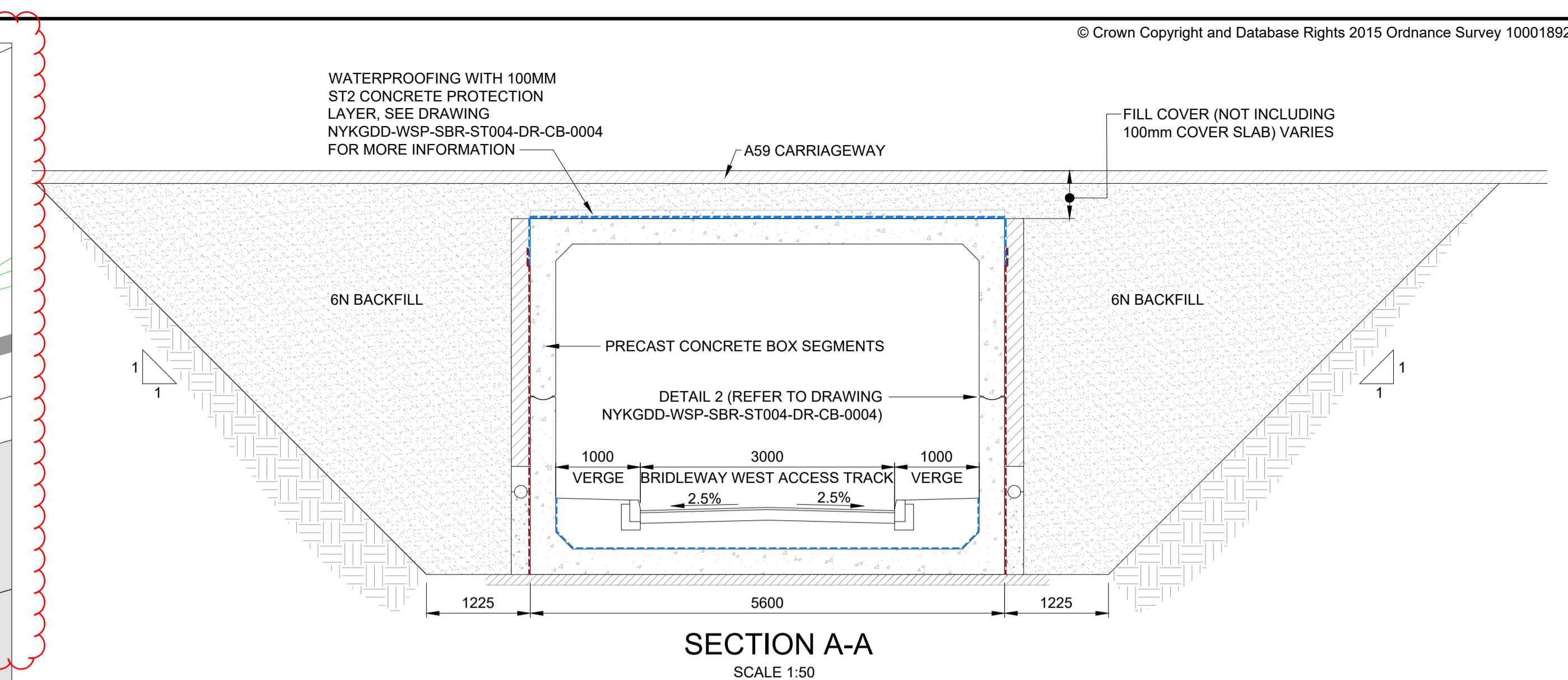
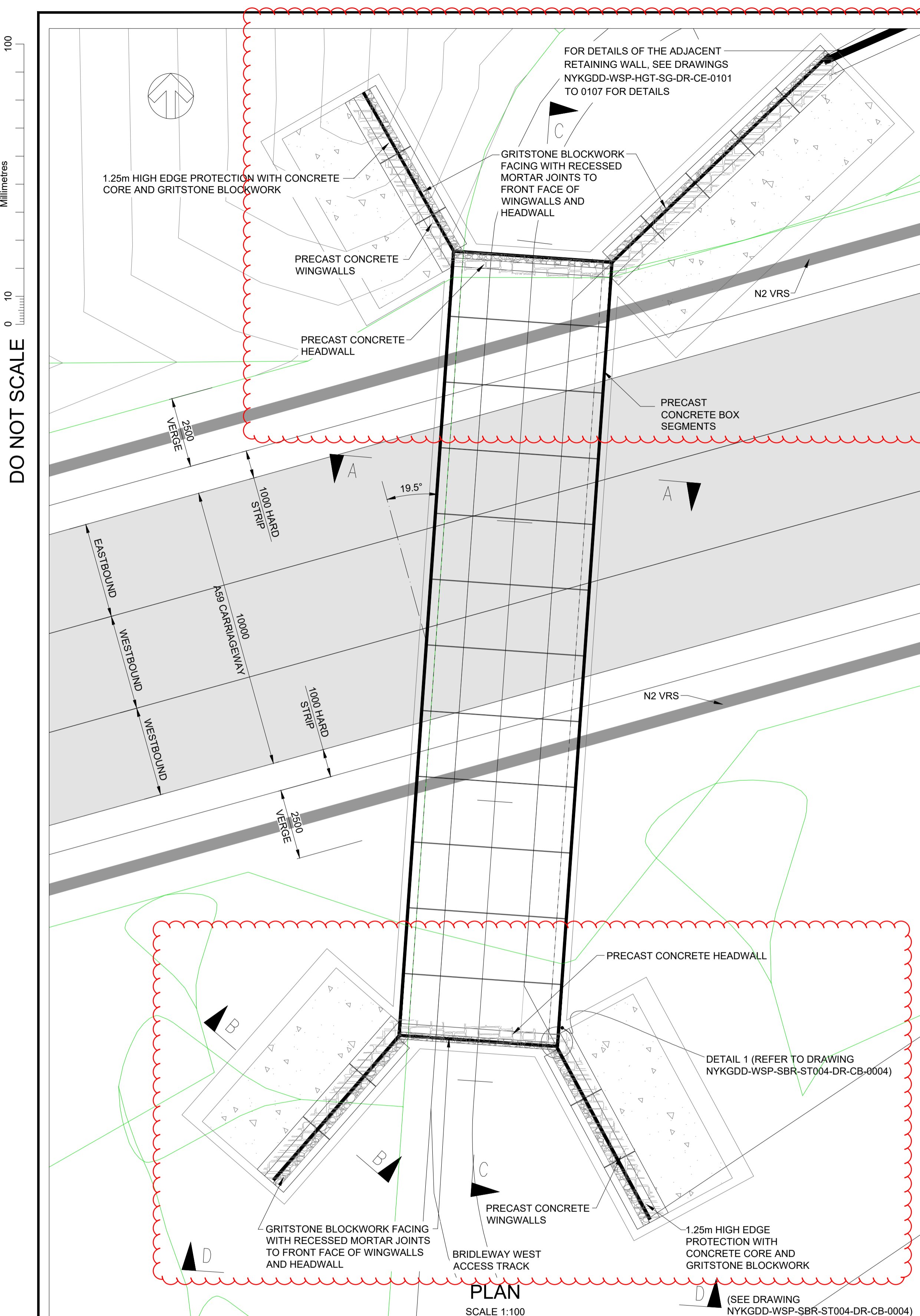
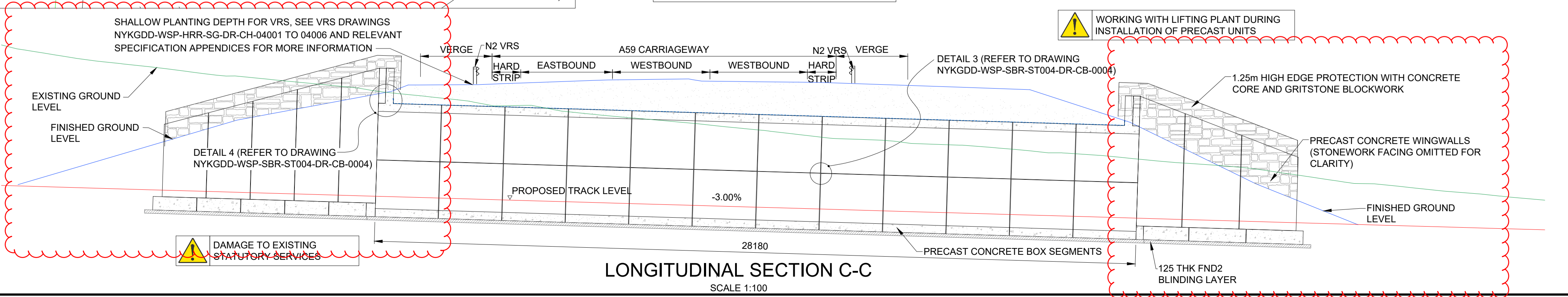

SAFETY, HEALTH AND ENVIRONMENTAL SYMBOL LEGEND
 ⚠ INDICATES A RESIDUAL RISK AS A WARNING

Rev.	Date	Description	By	Chkd	App'd
C01	27/07/23	FOR CONSTRUCTION ISSUE	LS	AA	HM

wsp
 3 Wellington Pl, Leeds LS1 4AP, United Kingdom
 T +44 (0) 113 395 6200, F +44 (0) 113 395 6201
 wsp.com

North Yorkshire County Council

Project Title: **A59 KEXGILL DIVERSION**

Drawing Title: **A59 KEXGILL WESTERN UNDERPASS (ST004) GENERAL ARRANGEMENT SHEET 1 OF 2**

Scale	Drawn	Checked	Approved	Authorised
AS SHOWN	LS	AA	HM	GC

Drawing Status: **FOR REVIEW** Suitability: **S3**

Drawing Number	Project	Originator	Volume	Project Ref. No.
ST004	NYKGGD	WSP	SBR	

DO NOT SCALE

Millimetres
0 10 100