

C15 C60 C65

DRAWING SCHEDULE	
DRAWING NUMBER	TITLE
NYKGGD-WSP-SMN-ST001-DR-CB-0001	GENERAL ARRANGEMENT SHEET 1 OF 2
NYKGGD-WSP-SMN-ST001-DR-CB-0002	GENERAL ARRANGEMENT SHEET 2 OF 2
NYKGGD-WSP-SMN-ST001-DR-CB-0003	STR001 SETTING OUT DETAILS
NYKGGD-WSP-SMN-ALL-DR-CB-0001	TYPICAL CULVERT DETAILS SHEET 1 OF 2
NYKGGD-WSP-SMN-ALL-DR-CB-0002	TYPICAL CULVERT DETAILS SHEET 2 OF 2

- ALL DIMENSIONS ARE IN MM UNLESS NOTED OTHERWISE.
- ALL LEVELS ARE IN METRES AOD UNLESS NOTED OTHERWISE.
- DO NOT SCALE FROM THIS DRAWING.
- THE DRAWING TO BE READ IN CONJUNCTION WITH THE SPECIFICATION FOR HIGHWAY WORKS, CONTRACT-SPECIFIC APPENDICES, DRAWINGS NYKGGD-WSP-SMN-ALL-DR-CB-0001, AND NYKGGD-WSP-SMN-ALL-DR-CB-0002, AND THE DRAWINGS LISTED IN THE SCHEDULE ON THIS DRAWING.
- THE CONTRACTOR SHALL MEASURE AND CONFIRM ALL DIMENSIONS/LEVELS THAT HAVE A DIRECT IMPACT ON THE WORKS PRIOR TO EXECUTION. IN CASE OF DOUBTS, OMISSIONS, OR ERRORS, THE CONTRACTOR NEEDS TO SEEK CLARIFICATION FROM THE NEC PROJECT MANAGER.
- FOR THE AFFECTED AREAS PRIOR TO WORKS, THE CONTRACTOR SHALL OBTAIN UP-TO-DATE UTILITY PLANS AND CARRY OUT SURVEYS TO POSITIVELY IDENTIFY AND MARK-UP ANY UTILITY APPARATUS. REFER TO APPENDIX 1/16 FOR FURTHER INFORMATION.

- GEOTECHNICAL**
- FORMATION INSPECTIONS SHALL BE UNDERTAKEN BY THE EMPLOYER'S SITE REPRESENTATIVE WHO SHALL BE A SUITABLY QUALIFIED GEOTECHNICAL ENGINEER. THE STRUCTURE IS ASSUMED TO BE FOUND ON WEATHERED BEDROCK. ANY 'SOFT SPOTS' SHALL BE EXCAVATED AND REPLACED IN ACCORDANCE WITH THE RELEVANT STANDARD EARTHWORKS DETAILS AND IN ACCORDANCE WITH THE SERIES 600 SPECIFICATION. THE NEC PROJECT MANAGER SHALL BE INFORMED IMMEDIATELY IF FORMATION MATERIAL DIFFERS FROM THAT ASSUMED WITHIN THE DESIGN.
  - PRECAST UNITS ARE TO BE FOUNDED ON SPREAD FOOTINGS AND THEY ARE TO HAVE THE FOLLOWING BEDDING DETAILS:
    - A GRANULAR BED WITH THE LOWER 150MM BEING 6N MATERIAL AND THE UPPER 50MM BEING CLASS 6L MATERIAL AS PER MCHW SERIES 600. EXCEPT FOR CLASS 6L, ONLY THE GRADING REQUIREMENT APPLIES AND NOT THE OTHER MATERIAL PROPERTIES LISTED IN TABLE 6/1 OF MCHW (BUT THE SULPHATE REQUIREMENTS OF CLAUSE 601 STILL APPLY).
    - ALTERNATIVELY, THE LOWER 150MM MAY BE REPLACED BY A 75MM MINIMUM THICKNESS BLINDING CONCRETE COMPRISING DESIGNATED CONCRETE FND2.
  - WHERE PRECAST UNITS ARE FOUNDED ON HARD MATERIAL (AS DEFINED IN BS 31) THEY SHALL BE LAID ON A TWO LAYER BED CONSISTING OF A LOWER 75MM MINIMUM BLINDING CONCRETE LAYER COMPRISING DESIGNATED CONCRETE FND2, COVERED BY AN UPPER 50MM MINIMUM GRANULAR LAYER OF CLASS 6L AS DESCRIBED ABOVE.
  - ALL BEDDING OPTIONS TO BE A MIN 300MM WIDER THAN THE PRECAST ELEMENTS AT OUTER EDGES.
  - THE LEVEL OF THE BOTTOM OF PRECAST UNITS TO BE ADJUSTED BASED ON THICKNESS OF CONTRACTOR DESIGNED PRECAST BOX BOTTOM SLAB IN ORDER TO ACHIEVE STATED INVERT LEVELS (ASSUMED 200MM SLAB THICKNESS WITH 300MM NATURAL BED SHOWN ON THIS DRAWING).
- STONE FACING AND STONE WALLS**
- REFER TO DRAWING NYKGGD-WSP-SMN-ALL-DR-CB-0002 AND SPECIFICATION APP 24/1 FOR DETAILS.

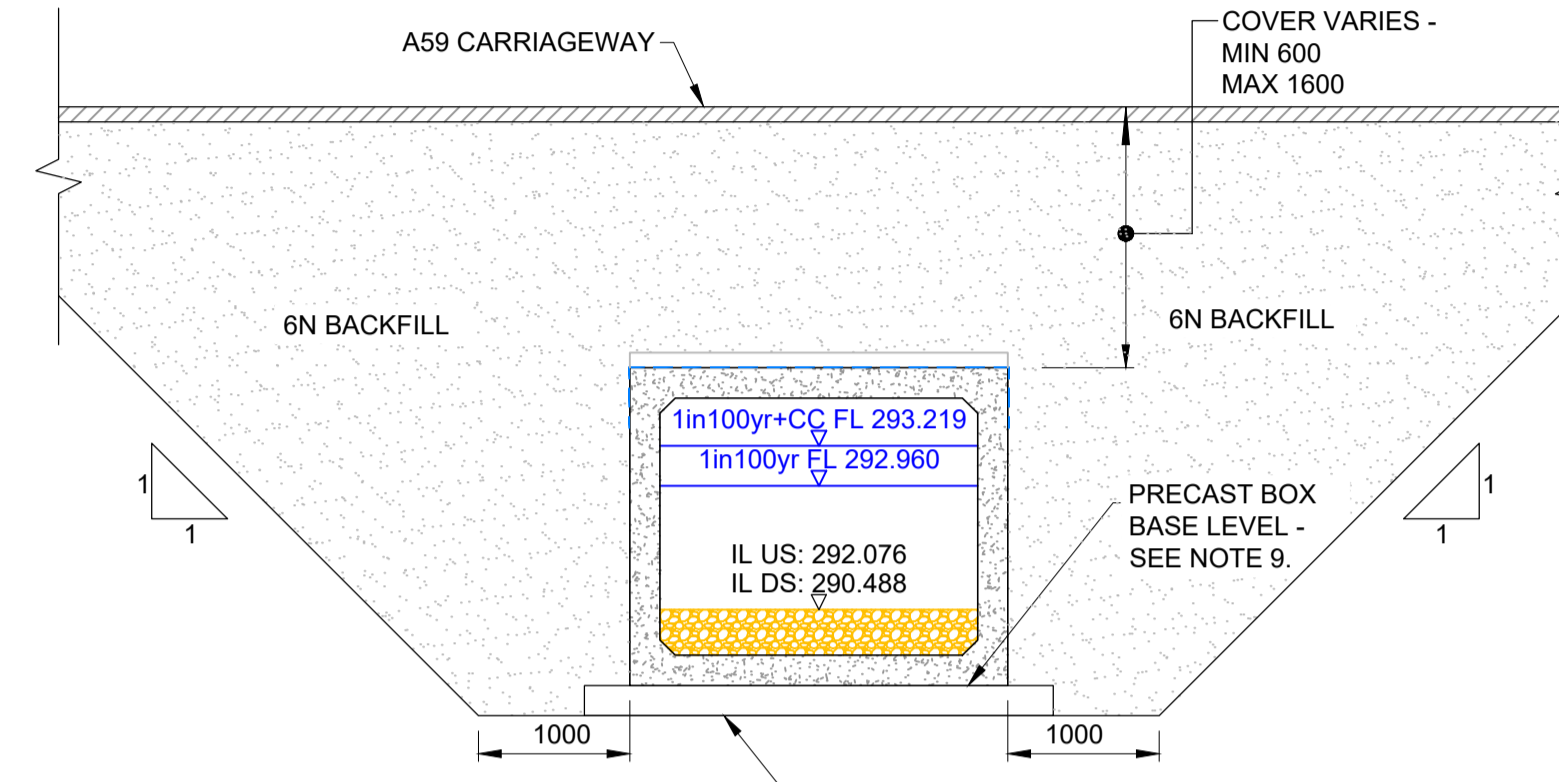

TYPICAL SECTION C-C

**INDICATIVE CONSTRUCTION SEQUENCE:**

- SET UP SITE COMPOUND
- INSTALL WATERCOURSE DIVERSION TEMPORARY WORKS
- INSTALL TEMPORARY WORKS TO SUPPORT EXCAVATION (UP TO NORTH MOOR ROAD/A59 JUNCTION)
- EXCAVATE TO FORMATION LEVEL OF BOX CULVERT AND WINGWALLS AND INSPECT GROUND CONDITIONS
- INSTALL PRECAST CONCRETE BOX CULVERT SEGMENTS
- INSTALL WINGWALLS TO NE ELEVATION
- INSTALL NATURAL BED AS WORK PROGRESS TO REDUCE CONFINED SPACE WORKING
- TEMPORARILY CLOSE EXISTING NORTH MOOR ROAD/A59 JUNCTION TO TRAFFIC
- INSTALL TEMPORARY WORKS TO SUPPORT EXCAVATION (FOR BOTH STRUCTURE NO.1 & 11)
- EXCAVATE AND REMOVE THE EXISTING PIPE CULVERT A (INCLUDING HEADWALLS/WINGWALLS) BENEATH NORTH MOOR ROAD AND INSPECT GROUND CONDITIONS
- INSTALL PIPE CULVERT STRUCTURE NO.11 INCLUDING CONNECTION SEGMENT WITH STRUCTURE NO.1
- INSTALL HEADWALL TO UPSTREAM OF PIPE CULVERT STRUCTURE NO.11
- INSTALL REMAINDER OF PRECAST CONCRETE BOX CULVERT SEGMENTS
- INSTALL WINGWALLS TO SW ELEVATION
- RETURN WATERCOURSE TO PERMANENT CHANNEL BACKFILL STRUCTURE IN A STAGED MANNER WITH HEIGHTS NOT DIFFERING BY MORE THAN 250MM AFTER COMPACTION ON OPPOSING SIDES.
- INSTALL PRECAST CONCRETE ACCESS CHAMBER.
- CONSTRUCT EMBANKMENTS AND NEW A59 CARRIAGEWAY
- INSTALL STONE CLADDING AND RAISED STONE WALL TO THE ENDS OF THE NEW CULVERTS
- INSTALL VRS TO THE NEW A59 VERGES
- OPEN EXISTING NORTH MOOR ROAD TO TRAFFIC AND COMMISSION NEW A59 ROAD ALIGNMENT

**NOTE WINGWALL AND HEADWALL ARRANGEMENTS/DIMENSIONS TO BE AGREED WITH NEC PROJECT MANAGER PRIOR TO CONTRACTOR FINALISING DETAILED DESIGN.**

**ALL CONTRACTOR DESIGNED ELEMENTS TO BE DESIGNED IN ACCORDANCE WITH APPENDIX 1/10 FOLLOWING SPECIFIED TECHNICAL APPROVAL PROCESS.**

**SAFETY, HEALTH AND ENVIRONMENTAL INFORMATION**

IN ADDITION TO THE HAZARDS/RISKS NORMALLY ASSOCIATED WITH THE TYPES OF WORK DETAILED ON THIS DRAWING, NOTE THE FOLLOWING SIGNIFICANT RESIDUAL RISKS

CONSTRUCTION
C15 - CONFINED SPACES (TANKS, TUNNELS, PITS, CULVERTS)
C60 - FLOOD RISK (PLUVIAL)
C65 - UNDERGROUND TELECOM

**SAFETY, HEALTH AND ENVIRONMENTAL SYMBOL LEGEND**

INDICATES A RESIDUAL RISK AS A WARNING

Symbol	Description
(Warning symbol)	INDICATES A RESIDUAL RISK AS A WARNING

Rev.	Date	Description	By	Chk'd	App'd
CD1	10/07/2023	ISSUED FOR CONSTRUCTION	SH	DM	DM

**wsp**

Three White Rose Office Park, Millshaw Park Lane, Leeds, LS11 0DL, UK  
T +44 (0) 113 395 6200, F +44 (0) 113 395 6201  
wsp.com

**North Yorkshire County Council**

Project Title: **A59 KEX GILL DIVERSION**

Drawing Title: **A59 KEXGILL CULVERT (STR001) GENERAL ARRANGEMENT SHEET 1 OF 2**

Scale	Drawn	Checked	Approved	Authorised
AS SHOWN	A	IM	HM	HM
Original Size	Date	Date	Date	Date
A1	05/05/20	05/05/20	05/05/20	05/05/20
Drawing Status	Suitability			
<b>FOR CONSTRUCTION ISSUE</b>	<b>A1</b>			
Drawing Number	Project	Originator	Volume	Project Ref. No.
NYKGGD	WSP	SMN		
Location	Type	Role	Number	Revision
ST001	DR	CB	0001	C01

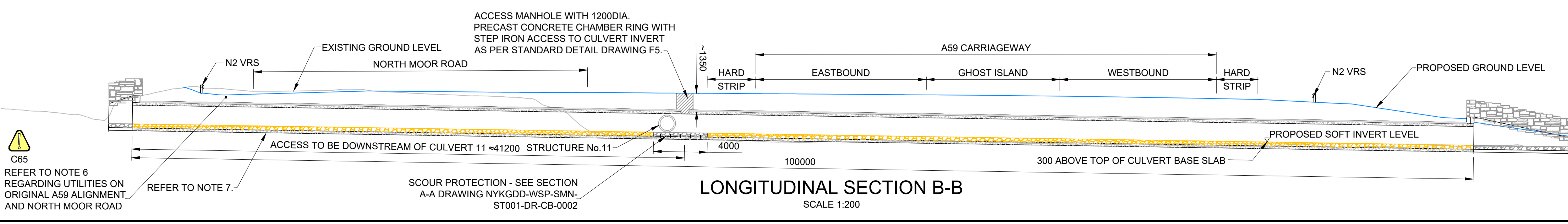
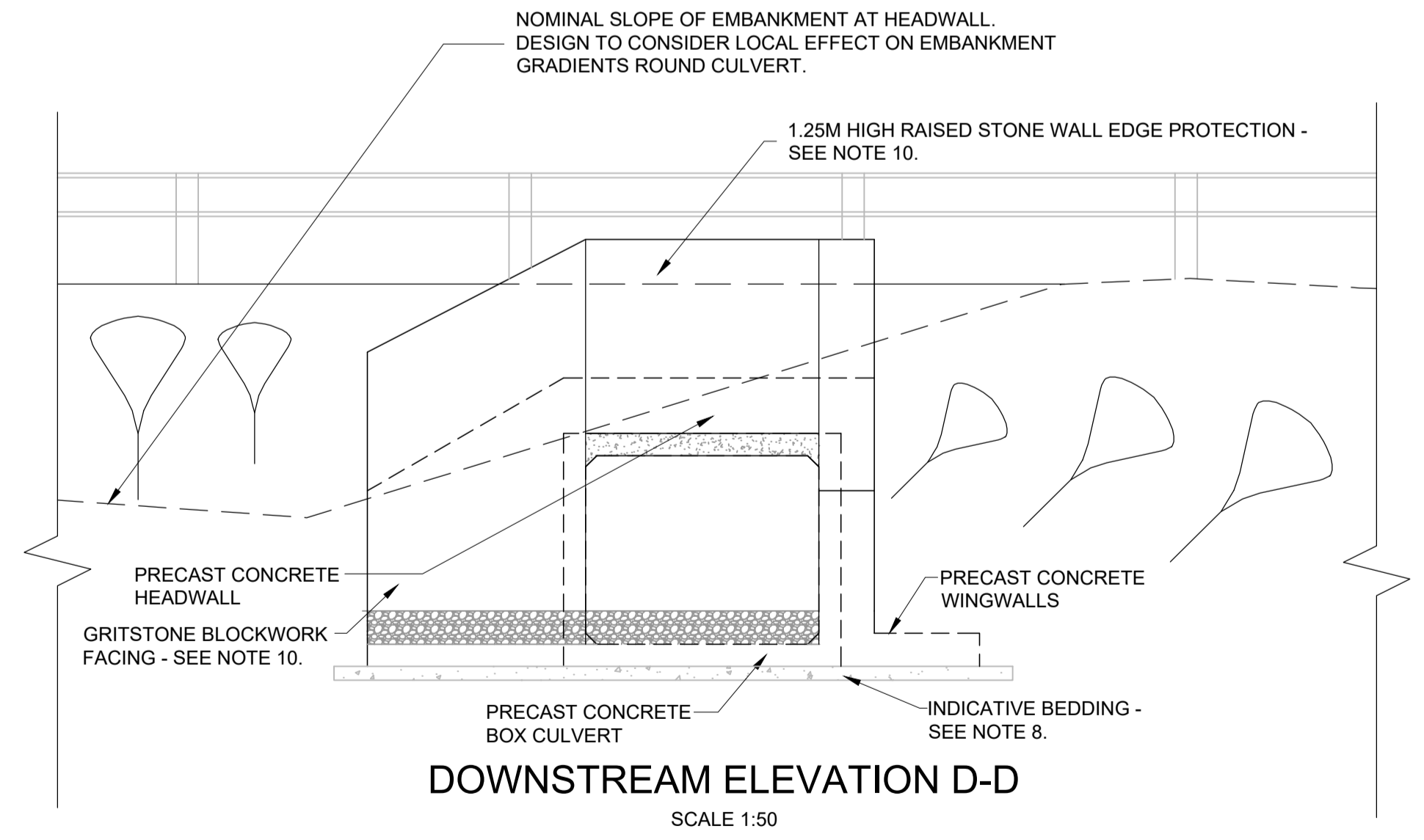
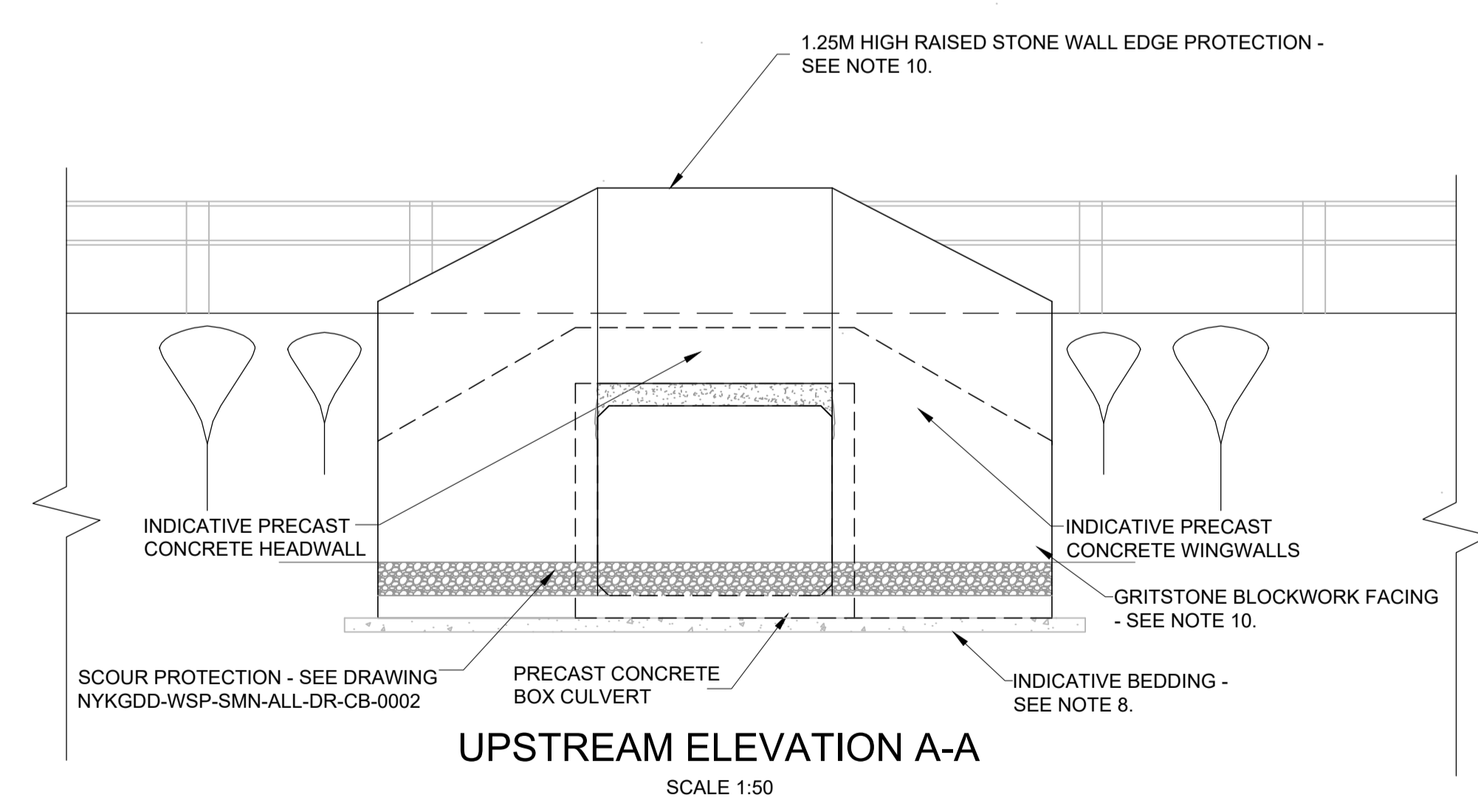
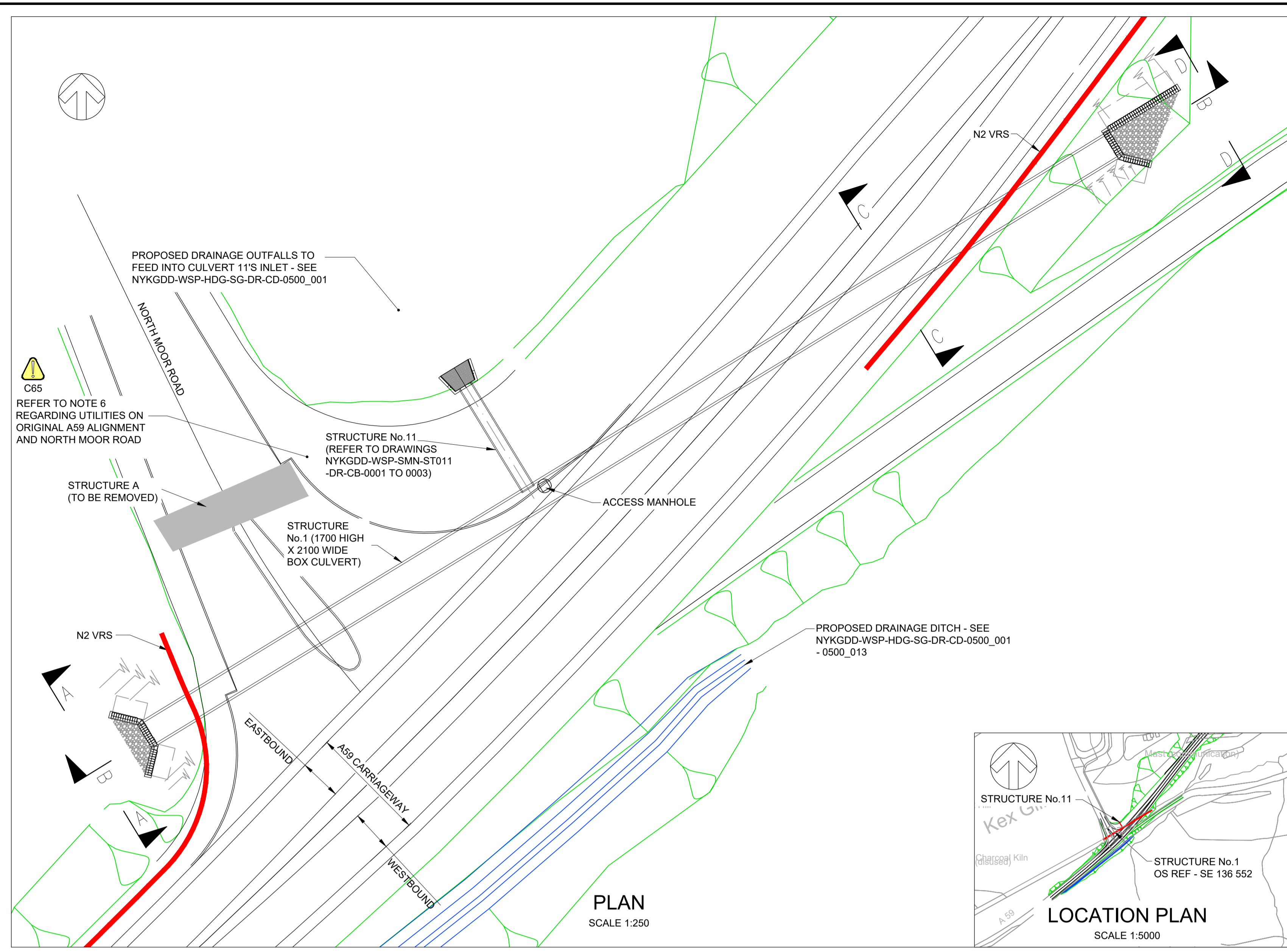

DO NOT SCALE

Millimetres

0 10 100

C65

REFER TO NOTE 6 REGARDING UTILITIES ON ORIGINAL A59 ALIGNMENT AND NORTH MOOR ROAD

REFER TO NOTE 7.

REFER TO NOTE 6 REGARDING UTILITIES ON ORIGINAL A59 ALIGNMENT AND NORTH MOOR ROAD

REFER TO NOTE 7.

REFER TO NOTE 6 REGARDING UTILITIES ON ORIGINAL A59 ALIGNMENT AND NORTH MOOR ROAD

REFER TO NOTE 7.

REFER TO NOTE 6 REGARDING UTILITIES ON ORIGINAL A59 ALIGNMENT AND NORTH MOOR ROAD

REFER TO NOTE 7.

REFER TO NOTE 6 REGARDING UTILITIES ON ORIGINAL A59 ALIGNMENT AND NORTH MOOR ROAD

REFER TO NOTE 7.