

Top Elevation - Existing
scale: 1:100 @ A3

A

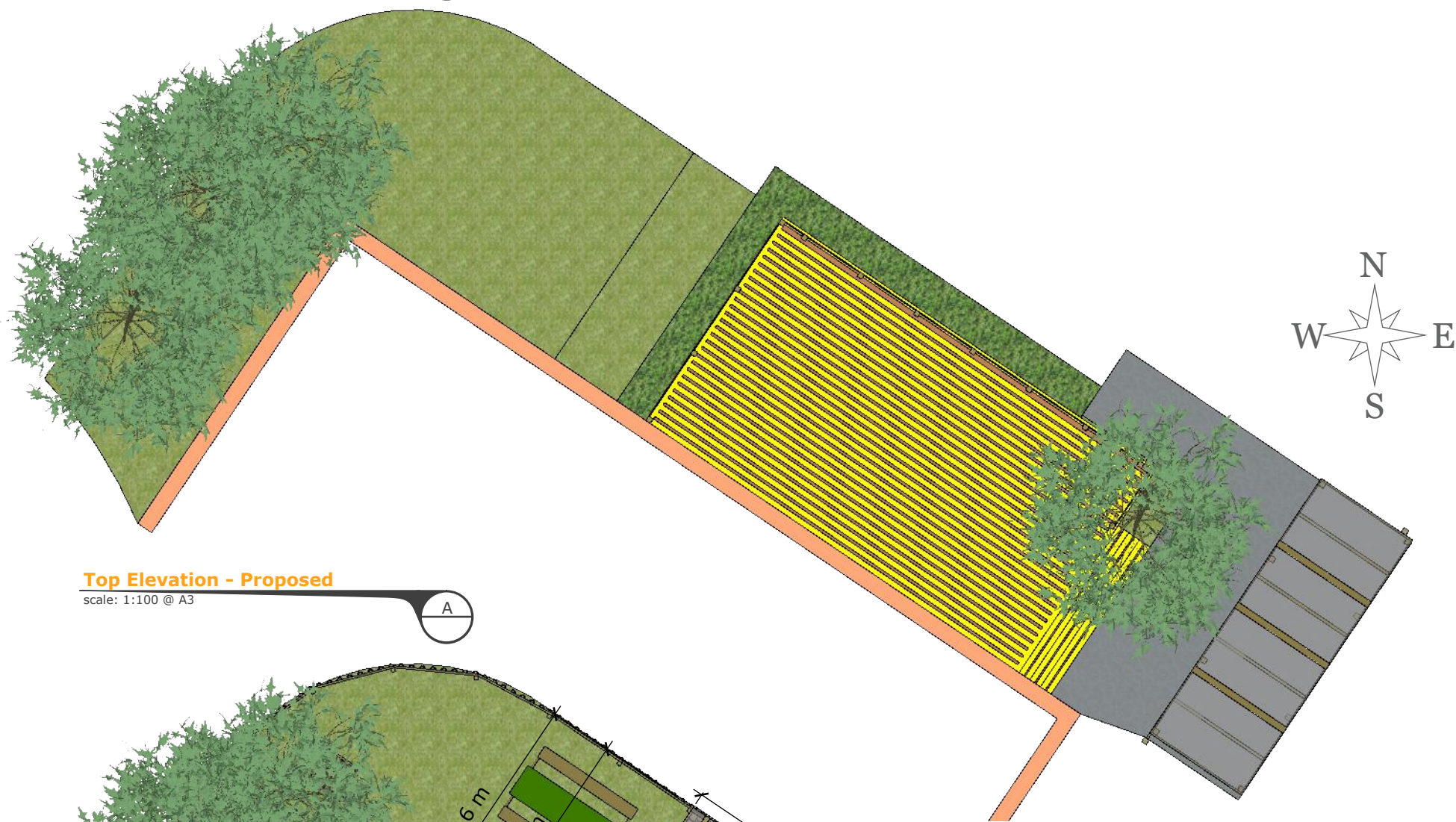

Top Elevation - Proposed
scale: 1:100 @ A3

A

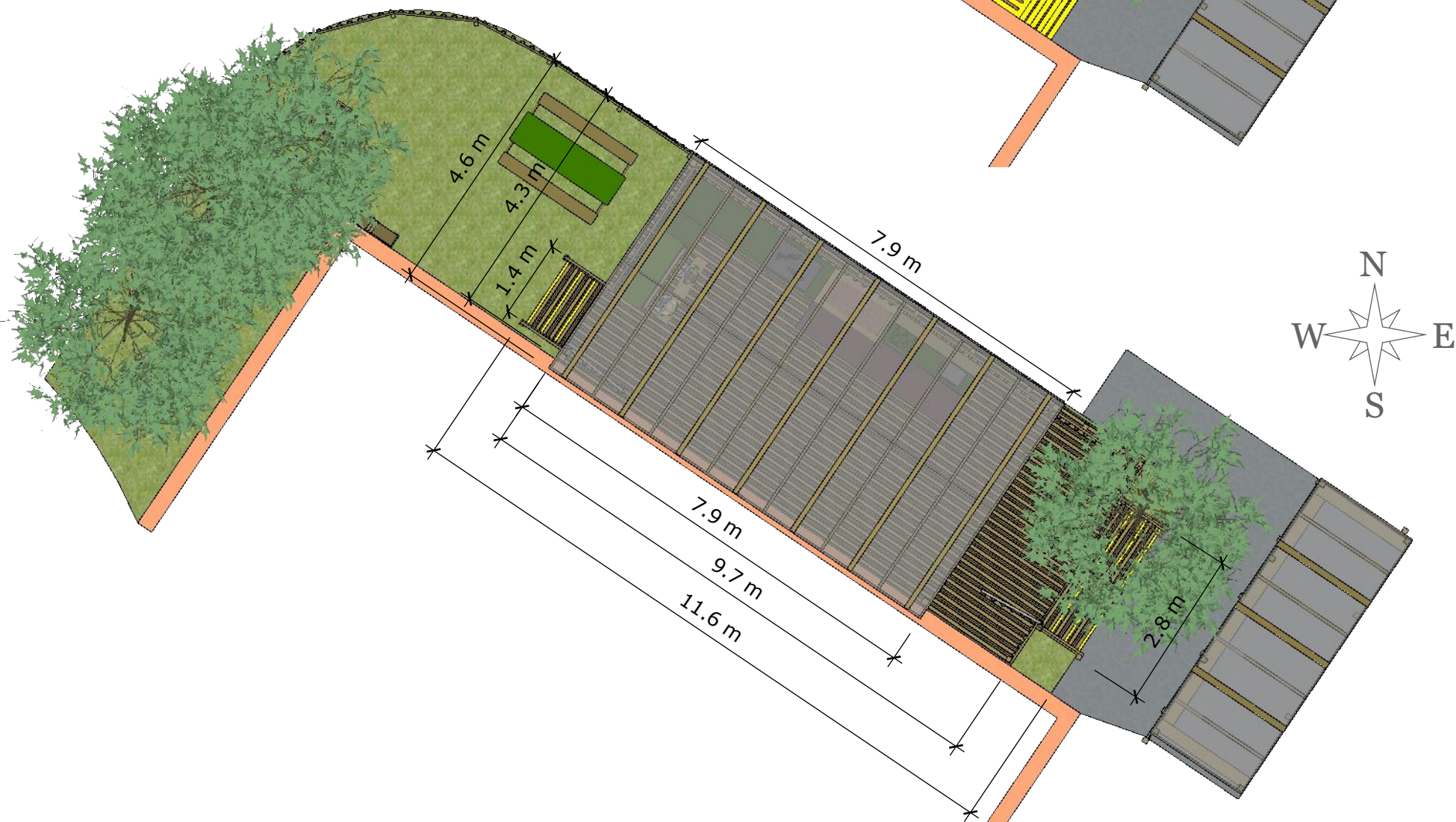

Description of the Proposal

Raised decked platform (9.7m x 4.3m) with fenced barriers, gated stair access and a polycarbonate roof canopy (7.9m x 4.6m). Role play, storage and nature equipment positioned as per the drawings.

Materials

Raised platform: 225 x 38mm pse pressure treated framework, 95 x 95 pressure treated leg supports with concrete foundations, slip resistant decking floor and stairs with yellow demarcations at change of level points.

Gates: Galvanised steel frames with timber cladding.

Shelter: 120 x 120mm pressure treasted GluLam leg supports with concrete foundations, 225 x 38mm pse pressure treated timber facia and joisting(600mm centres), 25mm triple wall polycarbonate roofing panels, 112mm guttering, brackets, clips etc and fall pipe as per manufacturers recommendations.



| | | |
|-------------------|--|----------------------|
| play-scheme.co.uk | Project : Long Marston Primary School | Date : 19.06.2019 |
| | | Contact : JD |
| | | Drawn By : DB |
| | Scheme Name : Shelter and Decking Area | Ref. No : 9187 |
| | | Revision of : |
| | Drawing Name : Elevations | Purpose of Revision: |

